

# Kampus kehittyvänä alustana – kampuskokemuksen jatkuva kehittäminen

- vuorovaikutus ja satunnaiset kohtaamiset
- Aalto Space -mobiiliapplikaatio

Satu Kankaala

Head of Workplaces and Sustainability

Aalto University Campus & Real Estate, Aalto University Properties Ltd

# Unique in Otaniemi campus

# ACRE

Aalto University  
Campus & Real Estate



# Campus Roadmap 2015-2021



## 2015-16

- Undergraduate Center opens at Otakaari 1, BIZ Bachelor students move (Aug 15)
- Learning Centre opens (Nov 16)
- ELEC relocation from Otakaari 5 to Maarintie 8 & 10 (Dec 16)
- Espoo 'School as a Service' high school starts at Puu2

## 2017

- Department of Film, Television and Scenography relocates from Arabia to Otakaari 7 (Jan)
- Dipoli opens as the new main building (Aug)
- University services relocation from Lämpömiehenkuja 2 and Innopoli 3 to Otakaari 1 and Dipoli (Aug)
- ENG exit from Innopoli 3
- Otakaari 5 Business Centre A Grid opens (Sep)
- Espoo 'School as service' expands to Open Innovation House (2017), Lämpömiehenkuja (2018/19)
- Metro starts operation to Otaniemi

## 2018

- Väre opens – Rest of ARTS relocate from Arabia to Otaniemi (Sep)
- Metro shopping centre opens (Sep)

## 2019

- Maarintie 13 opens – Rest of BIZ relocate from Töölö to Otaniemi (Sep)
- First Konemies block extension opens for ENG, Design Factory, Startup Sauna & others\*
- Otakaari housing built\*
- Kivimiehenranta development sold for housing
- Bionova phase 1 opens at Vuorimiehentie 2\*

## 2020-21

- Otakaari 2 A & B open (for Aalto Studios, SCI, ELEC, other university units)\*
- Second Konemies block extension opens\*
- Bionova phase 2, Student Centre and housing built\*

\*) Decisions to be made

Welcome  
to Dipoli

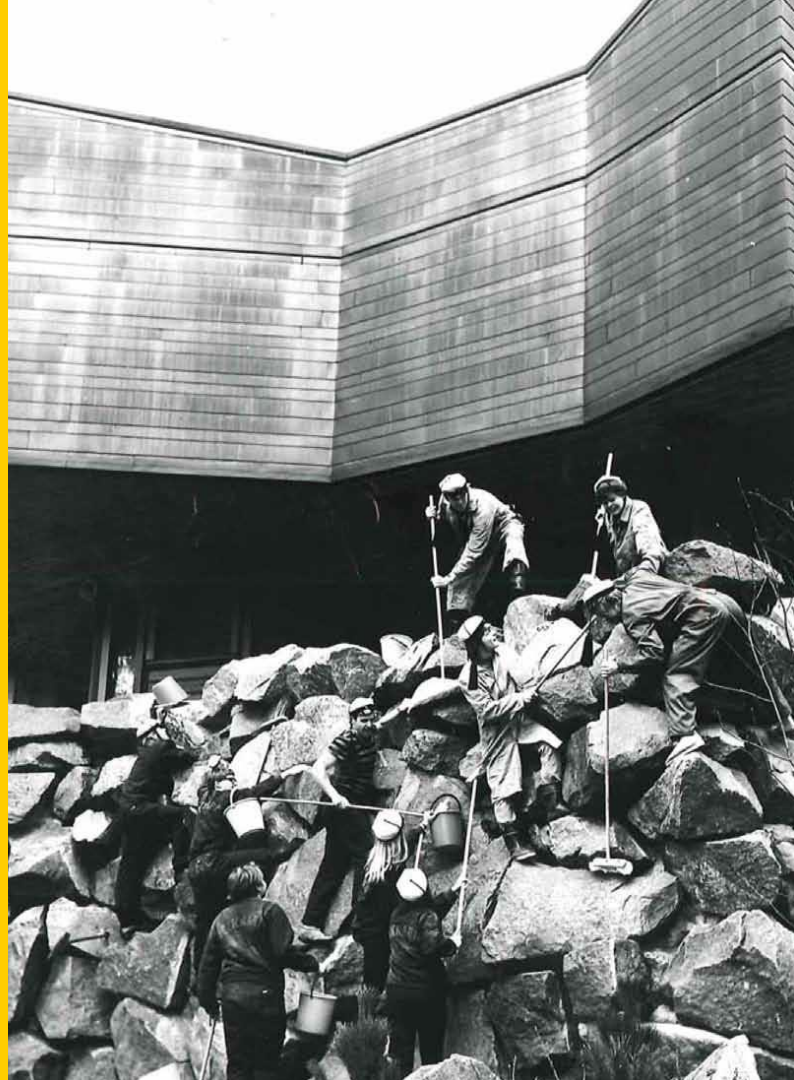

**Mix-use main building.  
Meeting venue. Test  
bed. Showroom. Vision  
co-designed with the  
community.**



**“Aalto Lobby”**



**Partnerships**

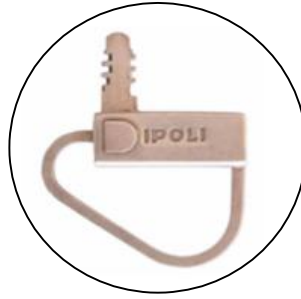

**Event concept**



**Activity based  
working**



**Interior design  
and Art**



**Restaurant  
concept**

A black and white photograph of a modern interior space. In the foreground, a large, rough, dark stone wall or sculpture is positioned on the right side. The floor is made of light-colored concrete. Several vertical concrete pillars support a ceiling with a series of horizontal concrete beams. In the background, a wide staircase with a dark carpeted upper section and a light-colored lower section leads upwards. The lighting is soft and even, highlighting the textures of the stone and concrete.

**Unique stories**

# 1<sup>st</sup> floor zones

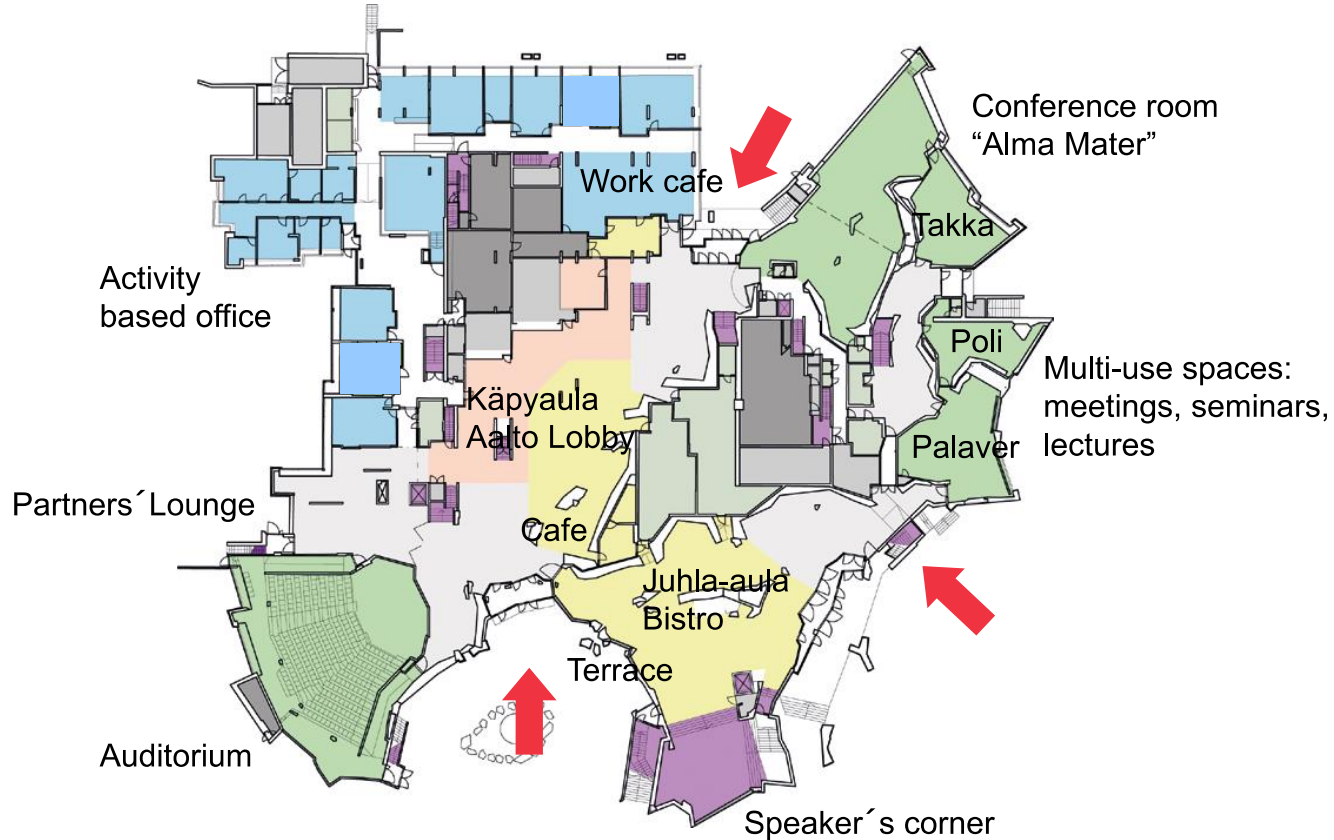



## 2<sup>nd</sup> floor zones

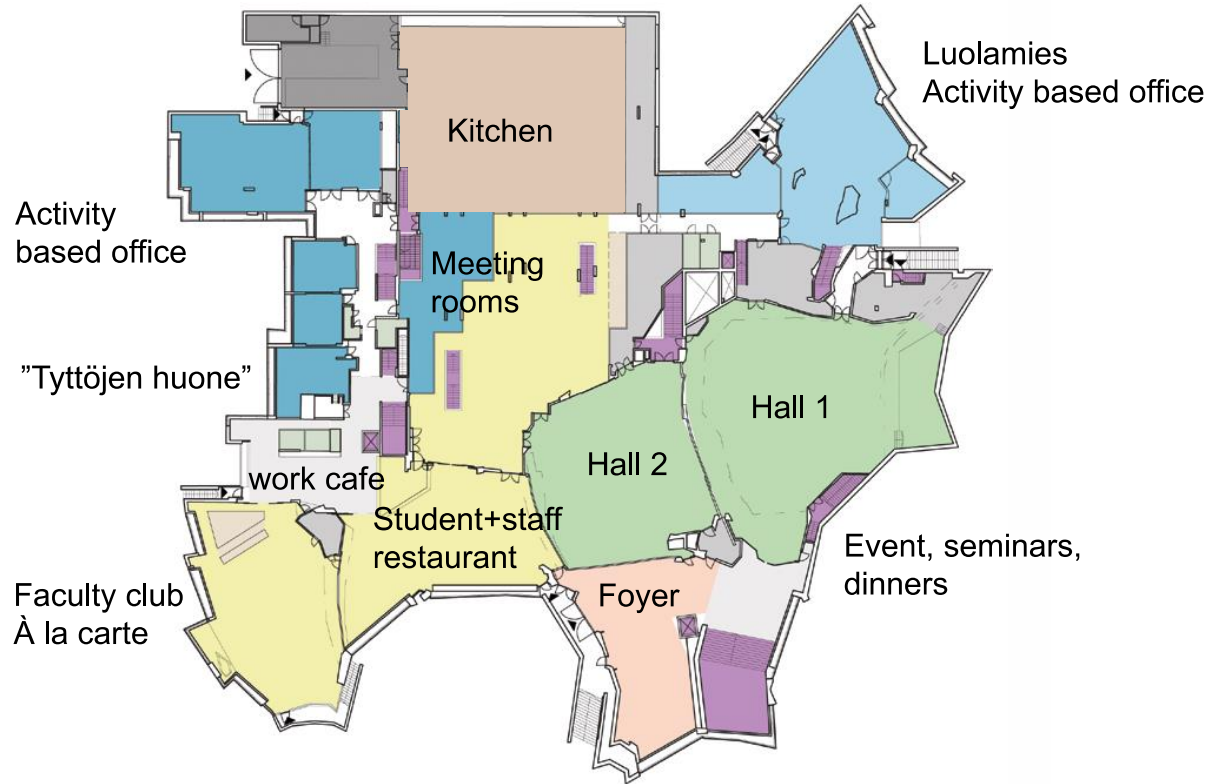

# Shared Use of Resources

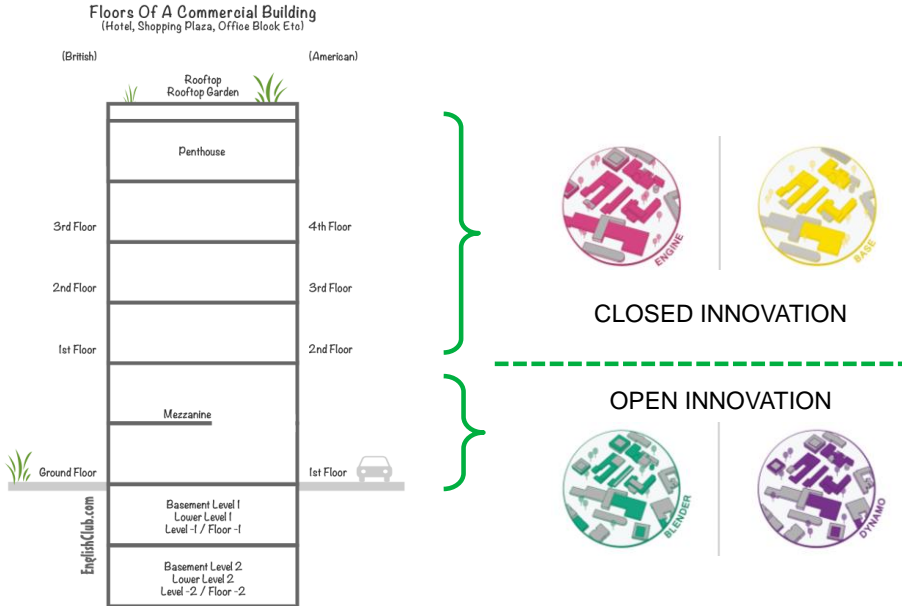

- Open innovation is introduced all over campus preferably on street level
- Resource sharing with different stakeholders in campus
  - Corporations
  - Start-ups
  - Public services etc.
- The aim is to enhance societal impact, intensify resource use and create added value for stakeholders

# Permanent Slush

1. **Design Factory - Innovations are created**
2. **Startup Sauna - Innovations are formed to startup firms**
3. **A Grid – a growth platform for Startup firms.**



**ACRE**  
Asilo University  
Campus & Real Estate

Aalto University  
Campus & Real Estate

- 2016
- 2017
- 2018
- 2019
- 2020

# Campus as workplace beyond 2020: network of places

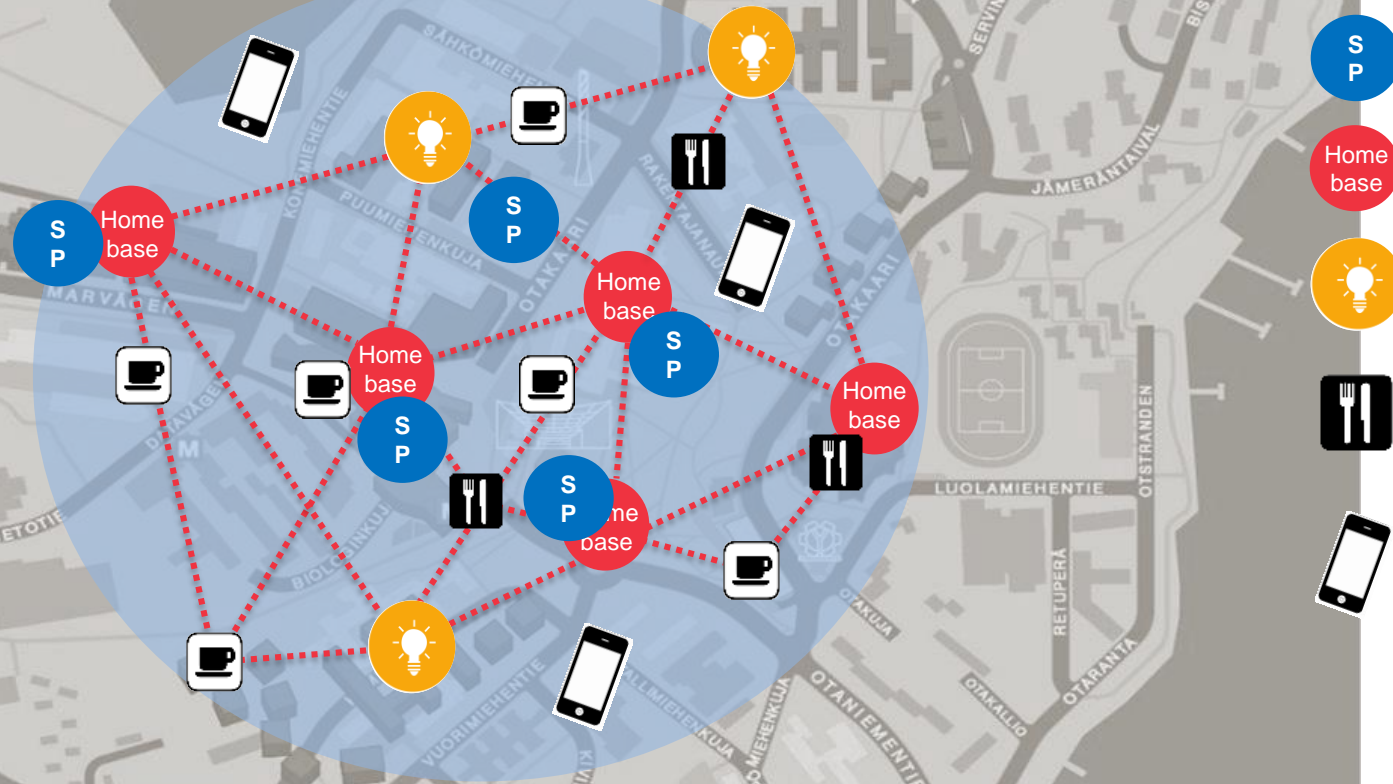

Campus is  
utilized as a  
whole

**S P**  
Service point:  
front office

**Home base**  
Home base:  
back office

**Hubs and  
coworking**

**Cafes and  
restaurants as  
third places**

**Mobile services  
accessible every  
where**





# CAMPUS MOBILE APPLICATION

## - Aalto Space

**ACRE**

Aalto University  
Campus & Real Estate



## *Lack of study space at Otakaari 1?*

### **Browse, choose & reserve with Aalto Space**

- Real time reservation status on spaces available for students
- Instant study and group work space reservation
- Indoor positioning and floor map navigation at Otakaari 1
- Emergency messaging through push notifications

[aaltocre.fi/aaltospace](https://aaltocre.fi/aaltospace)



**ACRE** Aalto University  
Campus & Real Estate

*Try  
and give  
feedback!*



# Features

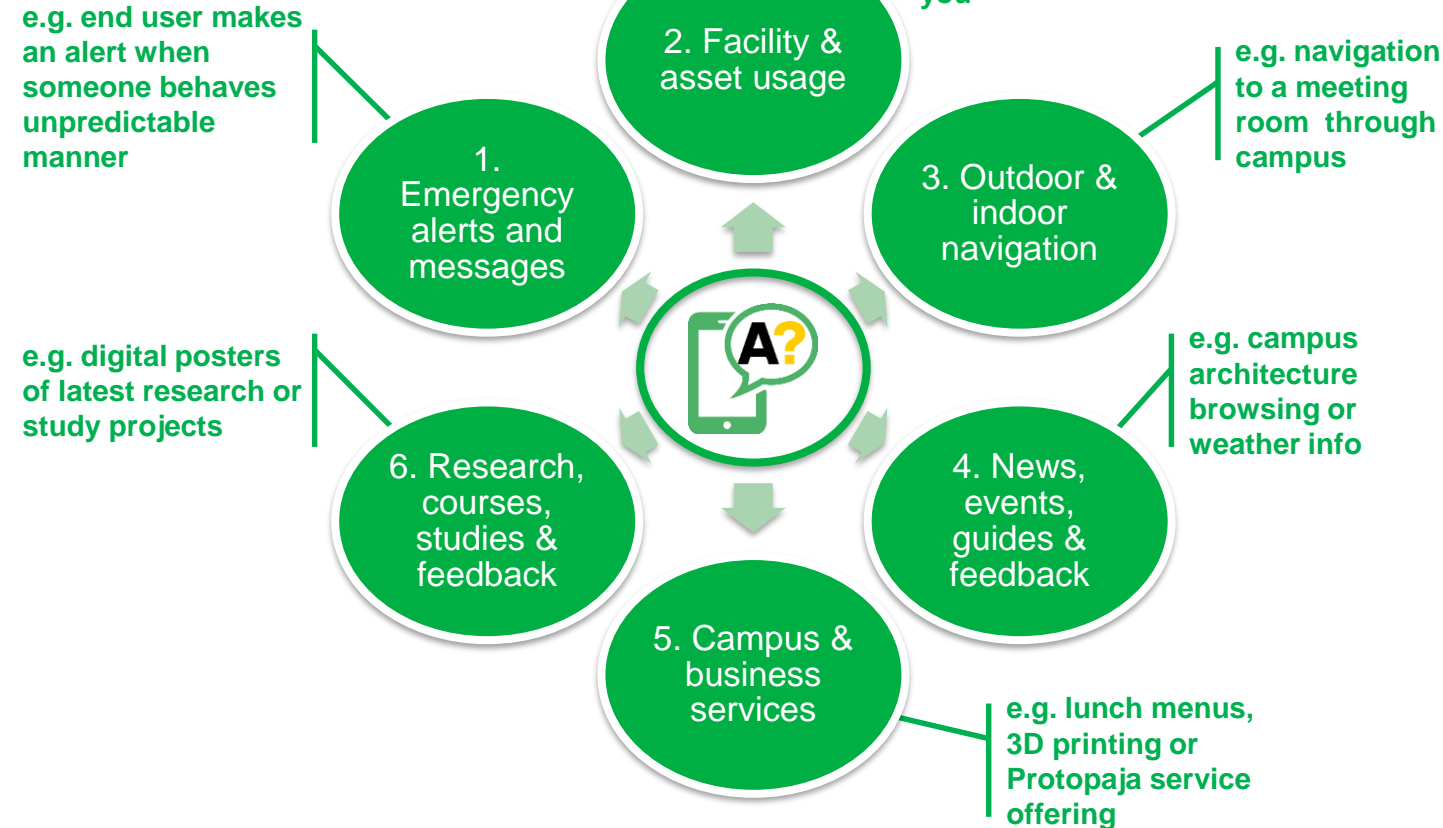

*Features  
1-3 in  
Aalto Space*

*Features  
4-6 in other  
Aalto  
applications  
?*

# Aalto Space status

19.4.2017

- August 2016: Silent release
- 5.9.2016 Flyers to new students and 15.9.2016 Roadshow in Otakaari 1
- Expanding to other buildings: Learning Center
- Development activities (1-6/2017)
  - Further development of the app according to the user feedback
  - Aalto ID identification or such
  - Web interface for Lumia users
  - Expanding to other buildings
  - Rating spaces

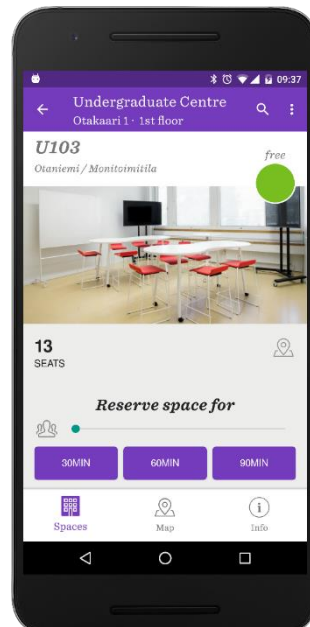

# ACRE

Aalto University  
Campus & Real Estate

*"This is a brilliant app. Love it <3 Thanks"*

*"Is it possible to check other buildings too?"*

- 20.4.2017: Yhteensä 3655 sovelluksen latausta, 1338 aktiivista käyttäjää 30 py:n sisällä
- Ajanjaksolla: 15.9.-31.10 appsi varausten määrä kasvattanut suhteellista varausastetta 49,3 %





Welcome to Aalto  
Otaniemi campus to  
give Aalto Space a try